

GENERAL PURPOSE PRESSURE TRANSDUCER

P3276B089601

Pressure sensor 0/1600bar 4-20mA DIN A

- Accuracy 0.5 %
- For relative/absolute pressure
- Pressure range from -1...0 bar to 0...2,500 bar
- Zero point and span adjustment



PRODUCT DESCRIPTION

Robust sensor with very good accuracy and a large number of measuring ranges. Possible to adjust zero point and span through potentiometers in the housing. Wide temperature range. Very high resistance to electromagnetic disturbances (EMC). Large range of special versions.

SPECIFICATIONS

| | |
|----------------------------|-------------------------------|
| Connection | Female thread |
| Connection Thread | M16x1,5F |
| EMC | EN61326 |
| IP Class | IP65 |
| Material of sensor housing | Stainless steel SIS2350 (316) |
| Materials Wetted Parts | Stainless steel SIS2350 (316) |
| Pressure Range Max | 1600 bar |
| Pressure Range Min | 0 bar |
| Response Time | 1 ms |
| Supply Voltage DC Max | 30 V DC |
| Supply Voltage DC Min | 10 V DC |
| Temperature ambient from | -20 °C |
| Temperature ambient to | 80 °C |

| | |
|------------------------------------|--------|
| Temperature compensated range from | 0 °C |
| Temperature compensated range to | 80 °C |
| Temperature range of media from | -30 °C |
| Temperature range of media to | 100 °C |

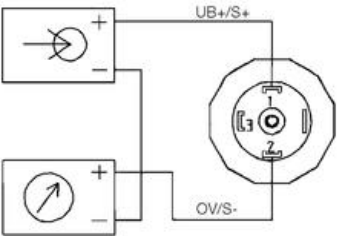
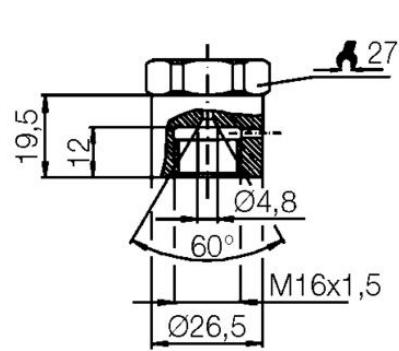

| | |
|------------------------|--------------|
| | 2-tråd mA |
| Matningsspänning UB+ | 1 |
| Matningsspänning 0V/S- | 2 |
| Signal S+ | |
| Signal 0V/S- | |

